

SELF-GUIDED TOUR MAP

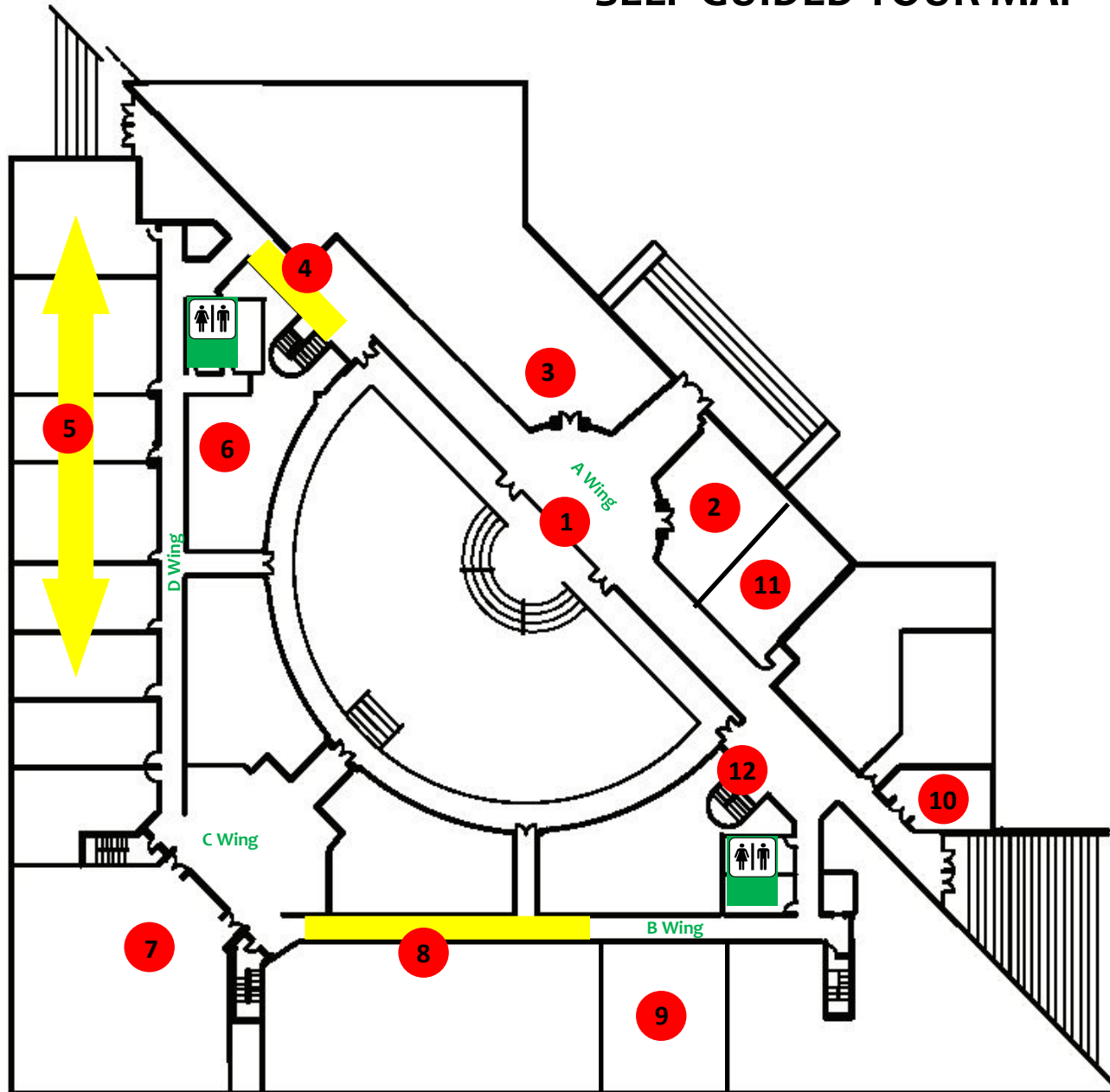

1. **Swearingen Lobby** Swearingen (built in 1987) is named after John E. Swearingen, a former USC Chemical Engineering student, class of 1938.
2. **The Wired Cafe** Opened in September 2018.
3. **Student Services - 1A00** Office of Academic Affairs and Academic Advisors.
4. **CEC Student Organizations List & Awards/ Trophies (left wall)** There are currently over 35 different engineering and computing student clubs and organizations in the CEC.
5. **Classrooms/Computer Labs** CEC students have 24/7 access to computers and printing.
6. **Server Room (high performance)** CEC has its own network server for high power and speed.
7. **Amoco Hall/Theater/Classroom - 1C01** Seats about 300; named after Amoco Oil Company (John Swearingen was the former President).
8. **Hall of Undergraduate Research (right wall)** Displayed are results of various undergraduate research projects. CEC students are encouraged to participate in research with faculty.
9. **Teaching Lab - 1B15 (example lab)** Students get hands-on classroom experience with faculty.
10. **CEC Tutoring Lab - 1A07** Peer tutoring - trained tutors are available; only college with its own separate Student Success tutoring branch.
11. **CEC Career Center- 1A03** Full-time staff assist with internships/co-ops, resumes, interviews, and host job fairs; only college with its own separate Career Center branch.
12. **Stairs - 2nd floor** Leads to classrooms in the 2A Hall; the class sizes average about 36:1.

Flip over for more CEC info!

Swearingen Engineering Center
301 Main St.
Columbia, SC 29208
www.cec.sc.edu

MAP OF CEC FACILITIES

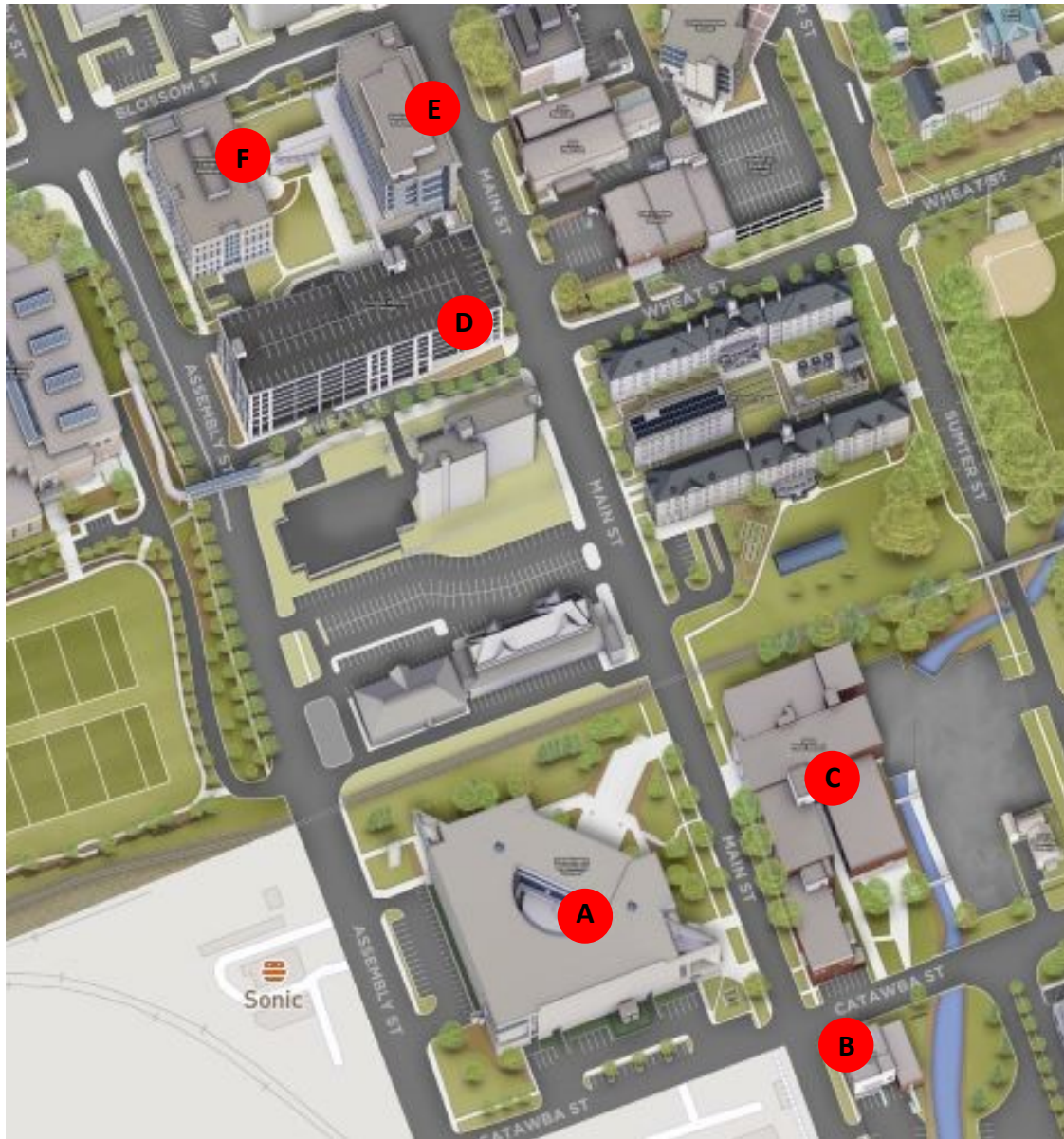

Map Key:

- A. **Swearingen Center - 301 Main St.** Classrooms, labs and offices; houses the Chemical, Biomedical and Electrical departmental offices.
- B. **Catawba Building - 1200 Catawba St.** Biomedical Engineering labs.
- C. **300 Main Building - 300 Main St.** Classrooms, labs and offices; houses the Mechanical, Aerospace, Nuclear, Civil & Environmental departmental offices.
- D. **Horizon Parking Garage - 519 Main St.** (First Floor) Classrooms.
- E. **Horizon Center - 541 Main St.** Offices and research labs.
- F. **Horizon II Innovation Center (IBM Building) - Corner of Blossom and Assembly St.** Classrooms and offices; houses the Integrated Information Technology, and Computer Science and Engineering departmental offices.

CEC Fun Facts:

- The USC College of Engineering was founded in 1909.
- CEC is the 3rd largest college on campus (enrollment).
- The Mechanical Engineering major has the largest student enrollment.
- We offer an Accelerated Masters program - students can get a Bachelor's and a Master's in 5 years.
- Biomedical, Chemical, and Civil majors have the highest female enrollment.
- Students have 24/7 access to computer labs and get 250 free prints per semester.
- The CEC is currently creating a 3-D Printing makerspace in Swearingen.
- As a freshman, there are no separate applications or requirements to be accepted into the College of Engineering and Computing.